

FOR APPROVAL ONLY

ONE (1) SET OF APPROVAL PRINTS
MUST BE SIGNED AND RETURNED TO
TRU INC. BEFORE EQUIPMENT
CAN BE RELEASED FOR PRODUCTION

APPROVED AS DRAWN
FOR FABRICATION

NOT APPROVED - REVISE &
RESUBMIT FOR FINAL APPROVAL

SIGNED _____

DATE _____

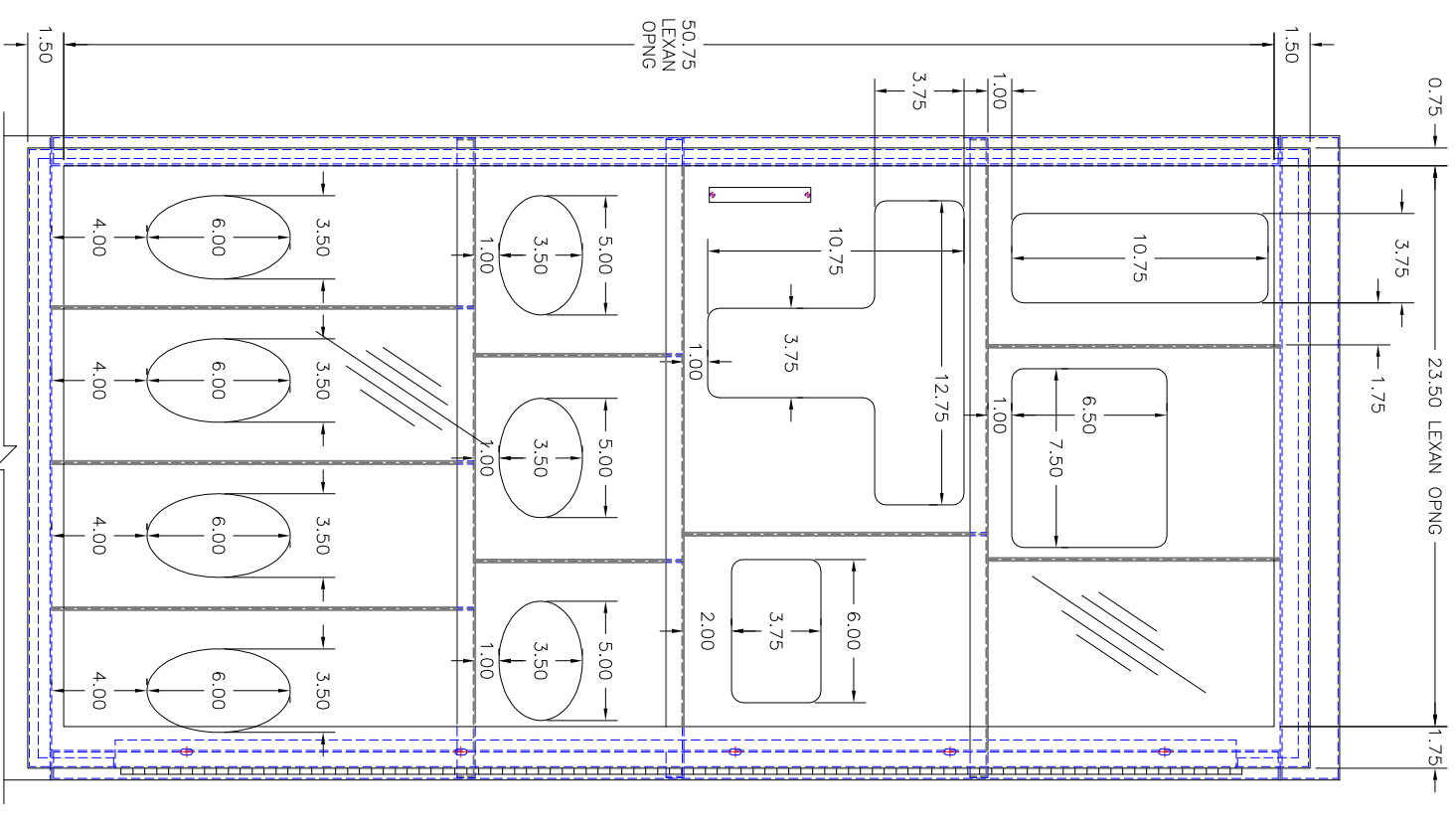
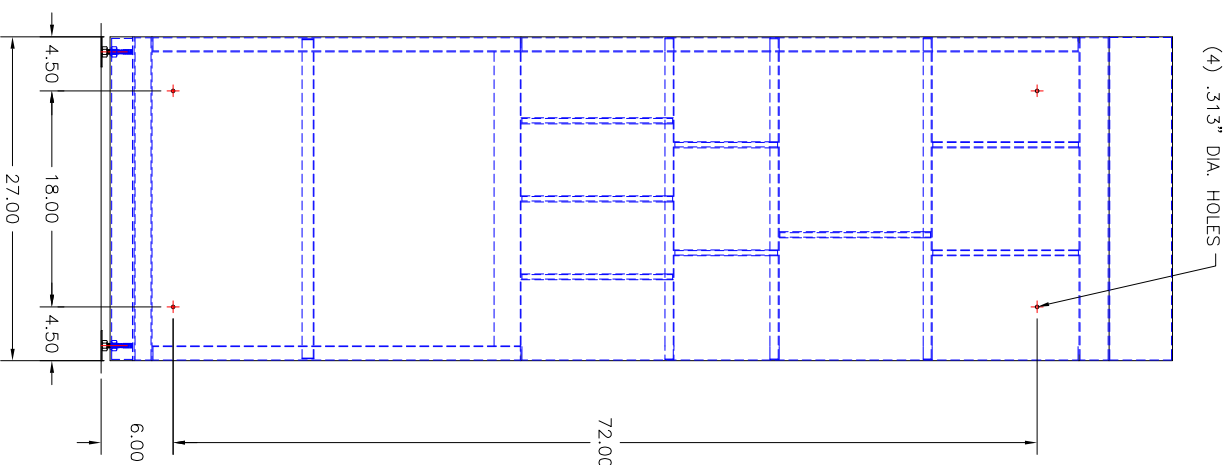
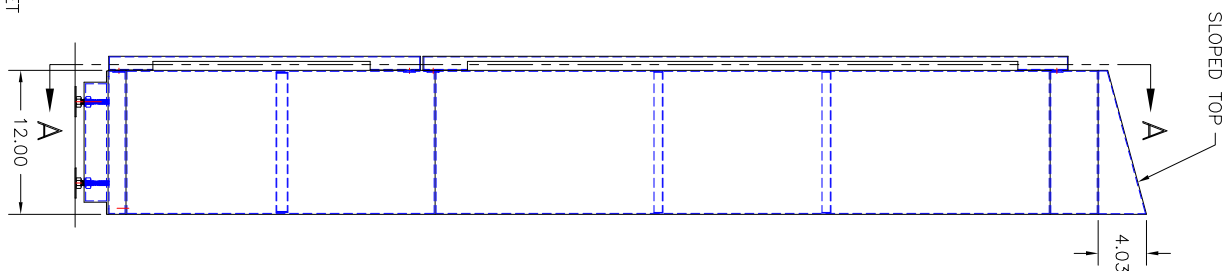
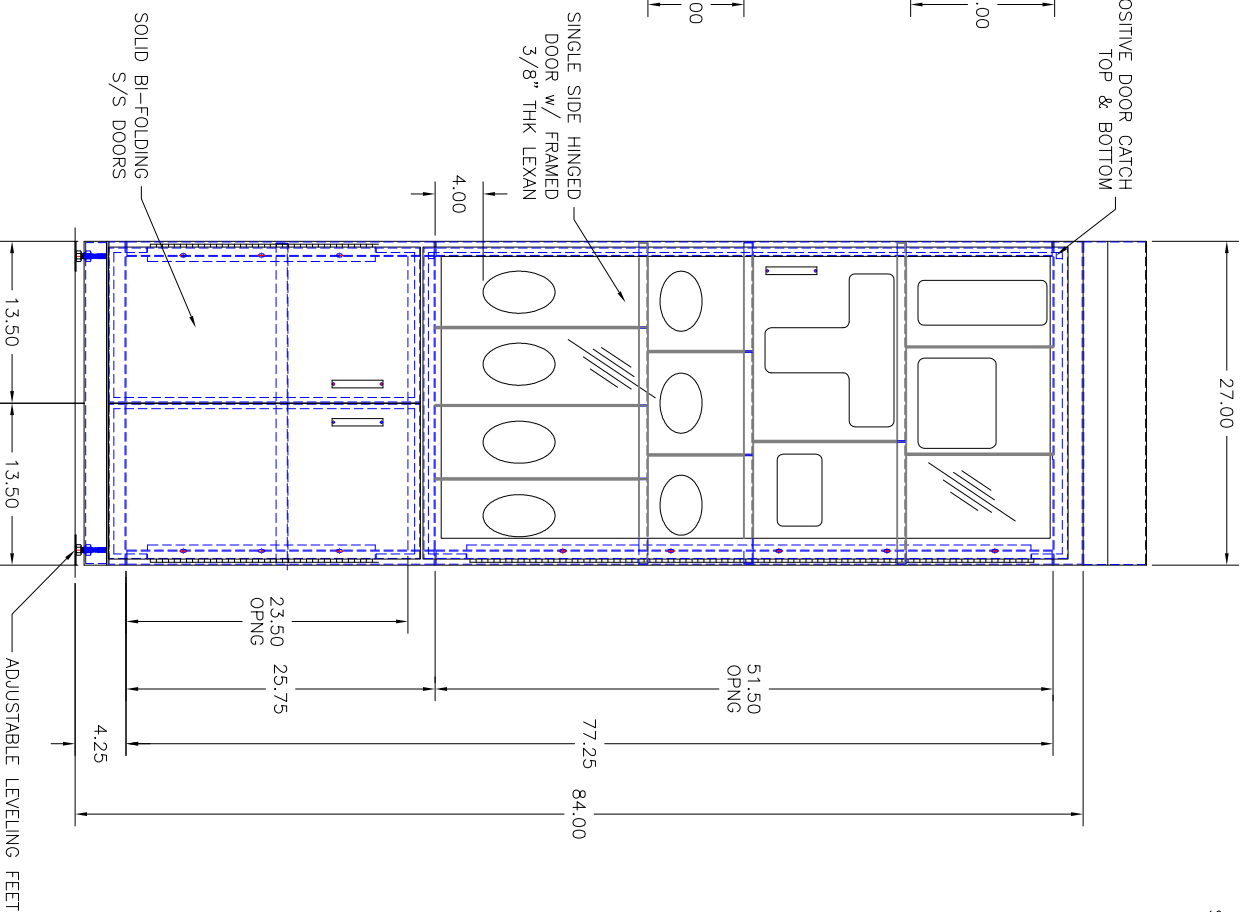
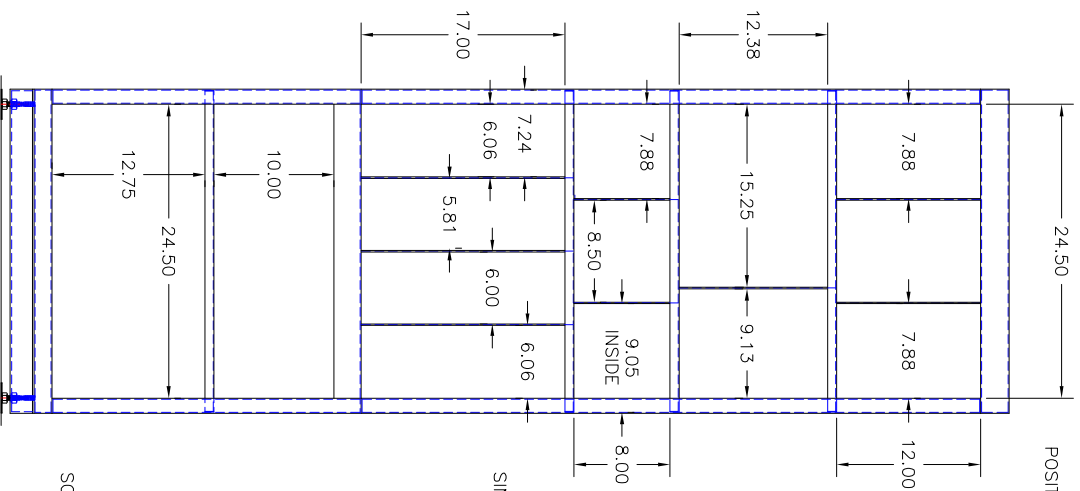
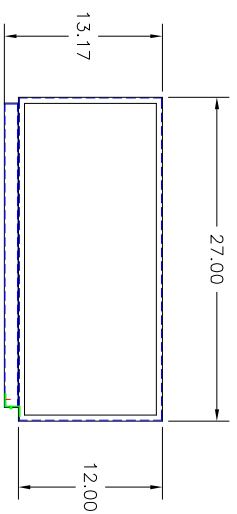

**SECTION A-A
COMPARTMENT LAYOUT**

**REAR VIEW
MOUNTING HOLE LOCATIONS**

**TYPE 304 STAINLESS STEEL CABINET CONSTRUCTION
w/ S/S FRAMED 3/8\"/>**

UNLESS OTHERWISE SPECIFIED	
TOLERANCES IN INCHES:	
FRACTIONAL ± 1/32	
ANGULAR ± 0.25°	
TWO DECIMAL ± 0.063	
THREE DECIMAL ± 0.031	
SCALE: 1/2"=1'-0"	
REF. DWG - R16011	
PROJ. RELEASE	-
APPR. RELEASE	-
REVIEWED BY	-
ENG. APPR.	-
LET	REVISION
BY	DATE
<p>TRU 1671 ORCHARD DRIVE CHAMBERSBURG, PA 17201 INCORPORATED Phone: (717) 261-9700 www.tbjinc.com</p>	
SCALE: 1/2"=1'-0"	DRAWN BY: ALE
REF. DWG - R16011	DATE: 5-9-18
MODEL: 12-27 SC - STORAGE CABINET	
ROUGH-IN ASSEMBLY	R18126

FOR APPROVAL ONLY

ONE (1) SET OF APPROVAL PRINTS
MUST BE SIGNED AND RETURNED TO
TRU INC. BEFORE EQUIPMENT
CAN BE RELEASED FOR PRODUCTION

- APPROVED AS DRAWN
FOR FABRICATION
- NOT APPROVED - REVISE &
RESUBMIT FOR FINAL APPROVAL

SIGNED _____
DATE _____

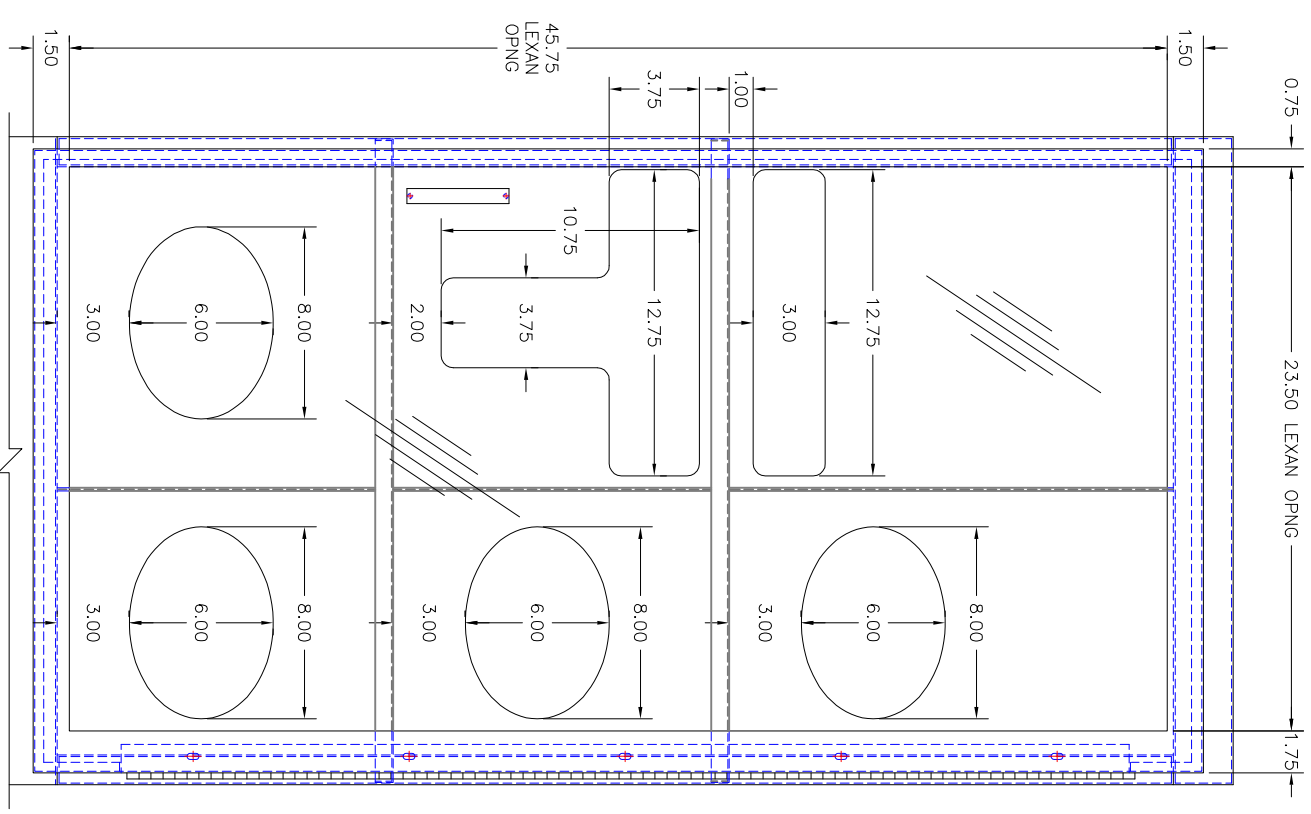
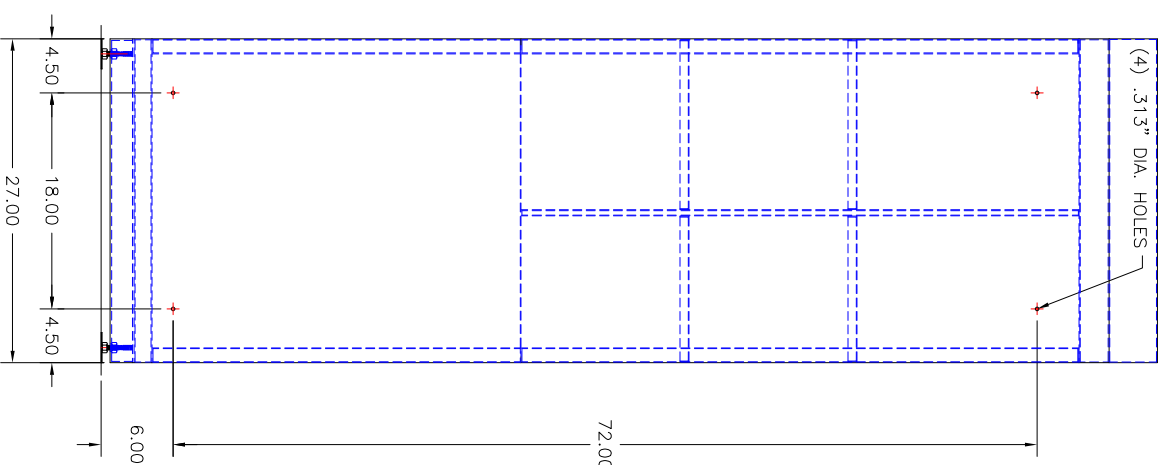
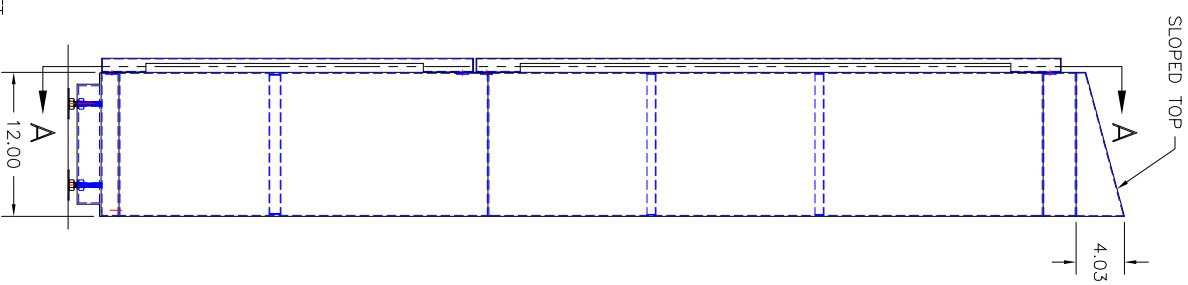
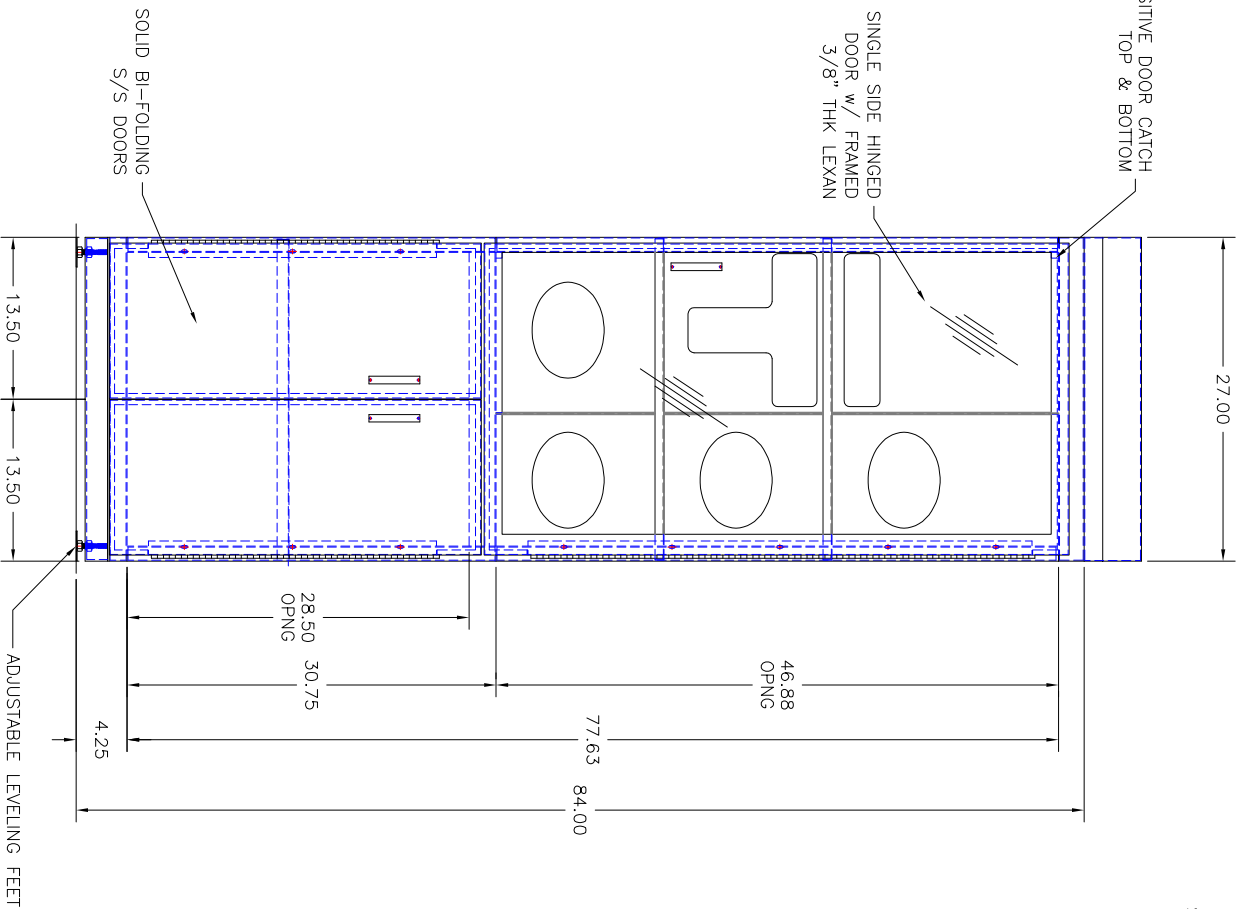
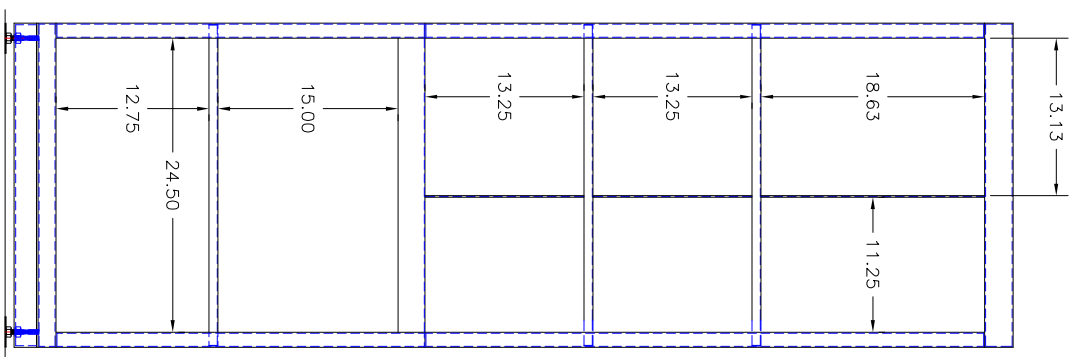
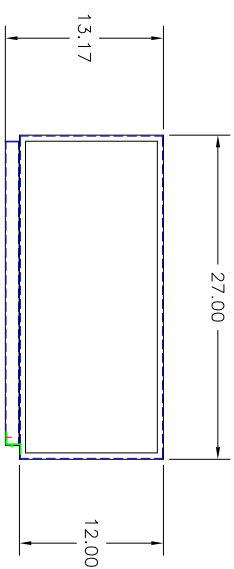

**TYPE 304 STAINLESS STEEL CABINET CONSTRUCTION
w/ S/S FRAMED 3/8" LEXAN UPPER DOOR**

**SECTION A-A
COMPARTMENT LAYOUT**

**REAR VIEW
MOUNTING HOLE LOCATIONS**

UNLESS OTHERWISE SPECIFIED		NAME	DATE
TOLERANCES IN INCHES:			
FRACTIONAL ± 1/32"			
ANGULAR ± 0.25°			
ONE DECIMAL ± 0.063			
TWO DECIMAL ± 0.031			
THREE DECIMAL ± 0.015			
PROJ. RELEASE	-	SCALE: 1/16"=1'-0"	DRAWN BY: ALE
APPR. RELEASE	-	REF. DWG - R16010	DATE: 5-9-18
REVIEWED BY	-	MODEL: 12-27 SC - STORAGE CABINET	
ENG. APPR.	-	ROUGH-IN ASSEMBLY R18125	